

ELKA 3 in 1 Lay

What Is Elka 3 in 1 Lay?

Elka 3 in 1 Lay Adhesive Underlay is the next generation in underlay for solid wood and engineered floors.

It is a sound reducing, thermal insulating underlay which will change the way fitters install real wood floors in the home or commercial place.

Elka 3 in 1 Lay is a closed cell cross linked polyolefin plastic foam underlay with an adhesive on one side protected by a polythene membrane.

The concept for this underlay is to make real wood floor installation a project achievable to the DIY and adding speed to the trade fitter reducing time on jobs.

It is estimated that you will save 60% -70% of time over traditional installation techniques with less mess and fuss.

What do I need?

Everything you need is in the pack of Elka 3 in 1 Lay.
1 x roll of underlay (Width 1m x Length 10m)
1 x additional application membrane
1 x instruction sheet

Technical Performance Data

Impact Sound Reduction:	22dB
Compressive Strength:	28kPa
Compressive Creep:	3kPa
Water Vapour Diffusion:	21m
Thermal Resistance:	0.088m ² K/W

How does it work?

Elka 3 in 1 Lay Adhesive Underlay works by adhering to the flooring being installed and keeping it in place. Its flexibility allows the floor to expand and contract naturally without unsightly gaps appearing. There is no longer the need for expensive tools and machinery to install solid and engineered real wood flooring. Secret nailing, gluing and clips are a thing of the past.

- 1 The floor planks are laid on top of the polythene membrane.
- 2 The membrane is peeled back.
- 3 The boards are then stuck to the underlay.

It's as easy as 1-2-3!



Features and advantages

- 3MM UNDERLAY WITH DPM / SOUND PROOFING / SELF ADHESIVE
- Handy lightweight 10m² roll
- Luxury 3mm underlay for use with solid floors up to 150mm and engineered floors up to 190mm
- Specialist installation over hard surface substrates
- Noise reducing, shock absorbent - impressive
- 22db sound reduction
- Foil backing with 50mm tape overlap giving an integrated sealed DPM system
- Self adhesive - bonds floor directly to underlay

Product Dimensions

Thickness:	3mm
Width:	1m
Length:	10m

ELKA 3in1 Lay

1 Elka 3 in 1 Lay must be laid on a flat surface which is dry, firm & level.

A floor is considered level if the deviation height is less than 2mm over a distance of 2.5 linear metres. Deviations above this level must be levelled out before laying the underlay. A newly laid concrete floor or screed must be allowed to dry to below 4% and readings confirmed with an impedance meter such as the Tramex CME4.

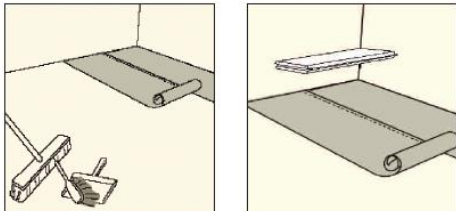

2 Roll out the underlay at 90° to the direction of the floor installation with the polythene side upwards.

Peel the polythene membrane back from the wall where the first row is to be installed. NB: When peeling the membrane back, only peel back to 90% of the width of the first row of flooring, not forgetting the 10/15mm expansion gap too. DO NOT touch the exposed adhesive surface.

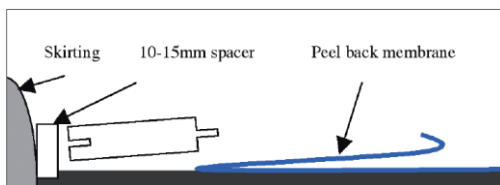

3 Now add the additional, loose membrane which can be found in the pack with the 'shiny' side face down on the adhesive. Fold the membrane back from the wall where the first row is to be installed.

The membrane should fold out into the room leaving enough material to take hold after the first row has been installed.

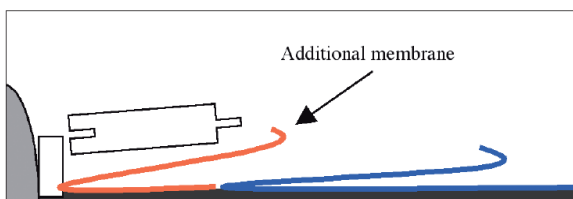

4 Install the first row ensuring the boards fit tightly together and the row is straight.

If the flooring is not straight at this point, you will experience gapping and other problems the more rows are installed. Installation straps can be a useful aide when fitting tongue and groove flooring.

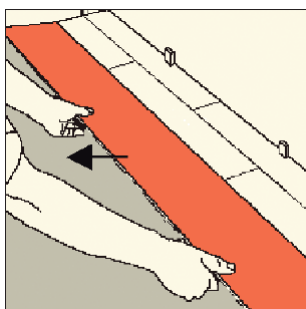

5 Once you have installed the first row, remove the loose membrane.

Take a hold of the spare material and gently peel back the membrane keeping pressure on the flooring to remain in place.

Once the flooring is in contact with the adhesive on the underlay, it will not be possible to readjust its position.

The loose membrane can now be discarded.

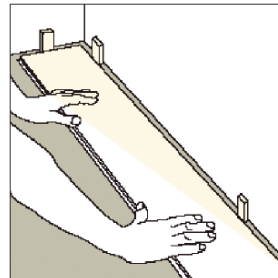

6 You may find that you need to reuse the loose membrane due to the width of your room. In this case, please follow the steps 3, 4 and 5 again until the first rows cover the entire width of the room.

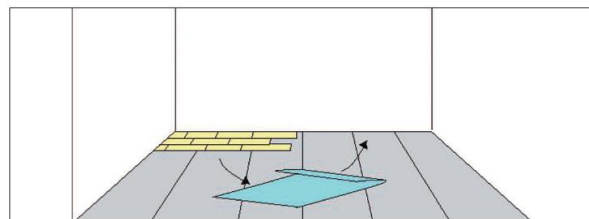

7 Install further rows by laying the planks on top of the folded membrane and once in position peel back the membrane from the underlay row by row.

If you find that you have removed too much of the membrane, just replace it back to the previous row tight against the boards.

If you are using the installation straps it may be possible to lay more and more rows at a time. As the installation progresses the amount of material which has been peeled back will increase allowing more rows to be installed and increasing the ease and speed of which a floor can be installed.

The straps will hold the boards in place whilst the membrane is removed. Refer to the manufacturers guidelines for the use of installations straps.

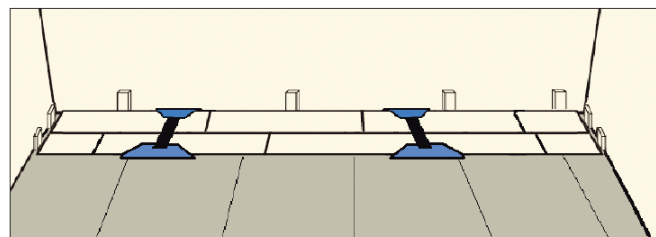
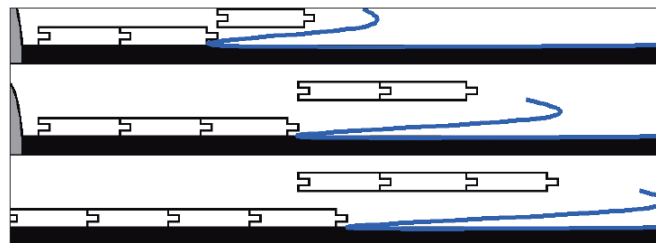

Do not forget to leave an expansion gap around the perimeter of the room. Consult your flooring manufacturer's instructions for details.